

Earless flanged ceramic package; 2 leads

SOT975B

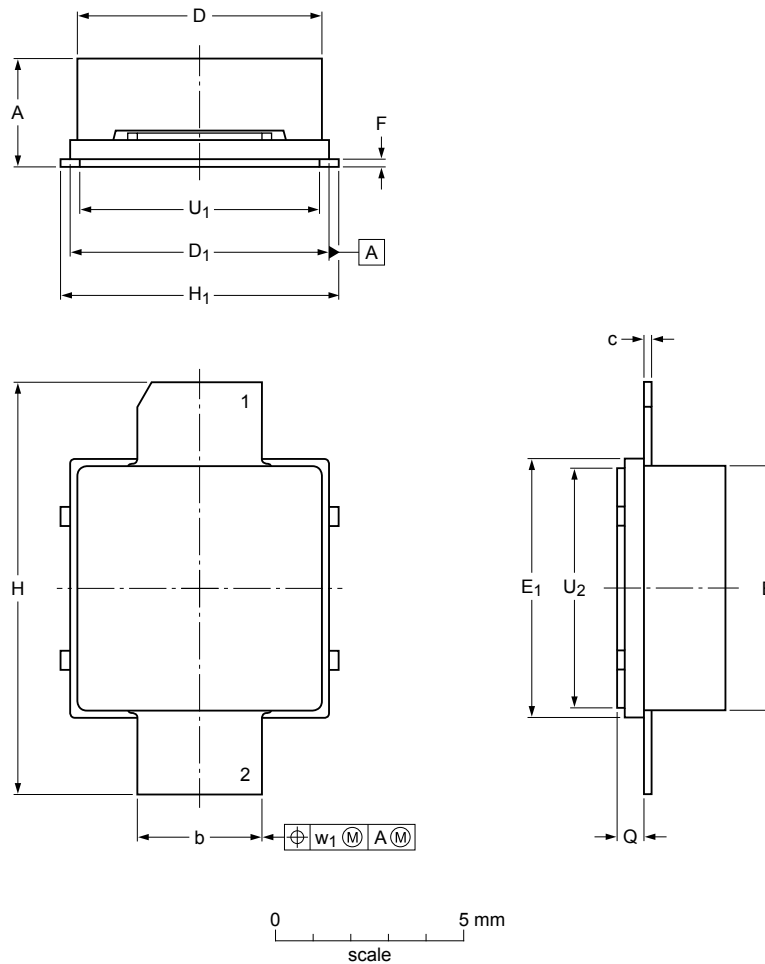

Dimensions (mm dimensions are derived from the original inch dimensions)

Unit	A	b	c	D	D ₁	E	E ₁	F	H	H ₁	Q	U ₁	U ₂	w ₁
mm	max	3.15	3.38	0.23	6.55	6.93	6.55	6.93	0.23	11.05	7.49	0.76	6.43	6.43
	nom													0.51
	min	2.59	3.23	0.18	6.40	6.78	6.40	6.78	0.18	10.80	6.73	0.66	6.27	6.27
inches	max	0.124	0.133	0.009	0.258	0.273	0.258	0.273	0.009	0.435	0.295	0.030	0.253	0.253
	nom													0.02
	min	0.102	0.127	0.007	0.252	0.267	0.252	0.267	0.007	0.425	0.265	0.026	0.247	0.247

sot975b_po

Outline version	References			European projection	Issue date
	IEC	JEDEC	JEITA		
SOT975B					07-09-28 14-10-20