

### Ceramic earless flanged cavity package; 2 leads

SOT922-1

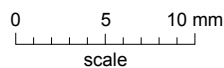
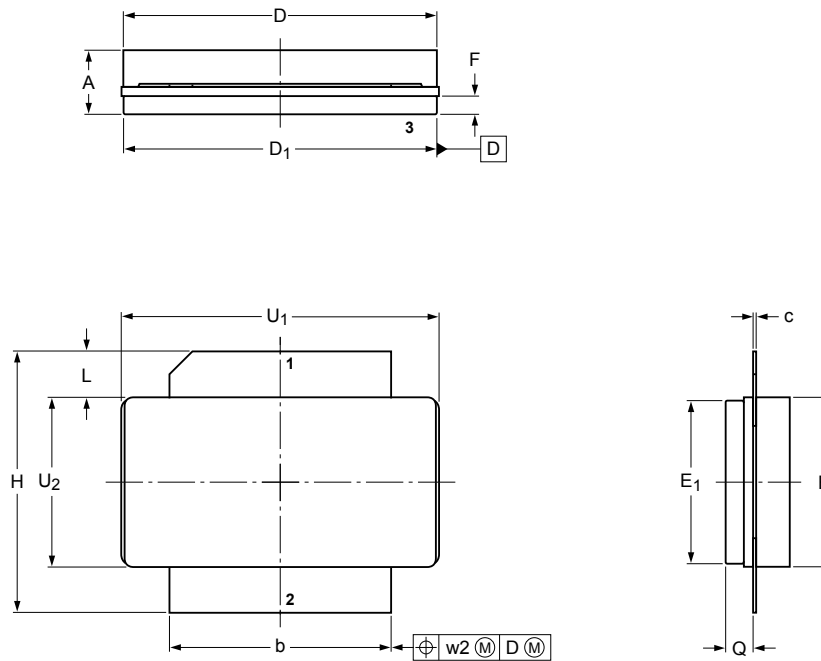

DIMENSIONS (mm are the original dimensions)

UNIT	A	b	c	D	D <sub>1</sub>	E	E <sub>1</sub>	F	H	L	Q	U <sub>1</sub>	U <sub>2</sub>	w <sub>2</sub>
mm	4.22 3.53	12.42 12.17	0.15 0.10	17.58 17.22	17.50 17.25	9.53 9.27	9.27 9.02	1.32 0.81	15.62 14.34	3.05 2.03	1.70 1.45	17.75 17.50	9.53 9.27	0.25
inches	0.166 0.139	0.489 0.479	0.006 0.004	0.692 0.678	0.689 0.679	0.375 0.365	0.365 0.355	0.052 0.032	0.615 0.525	0.12 0.08	0.067 0.057	0.699 0.689	0.375 0.365	0.010

OUTLINE VERSION	REFERENCES				EUROPEAN PROJECTION	ISSUE DATE
	IEC	JEDEC	JEITA			
SOT922-1						05-11-14 05-11-22