

Flanged ceramic package; 2 mounting holes; 4 leads

SOT1130A

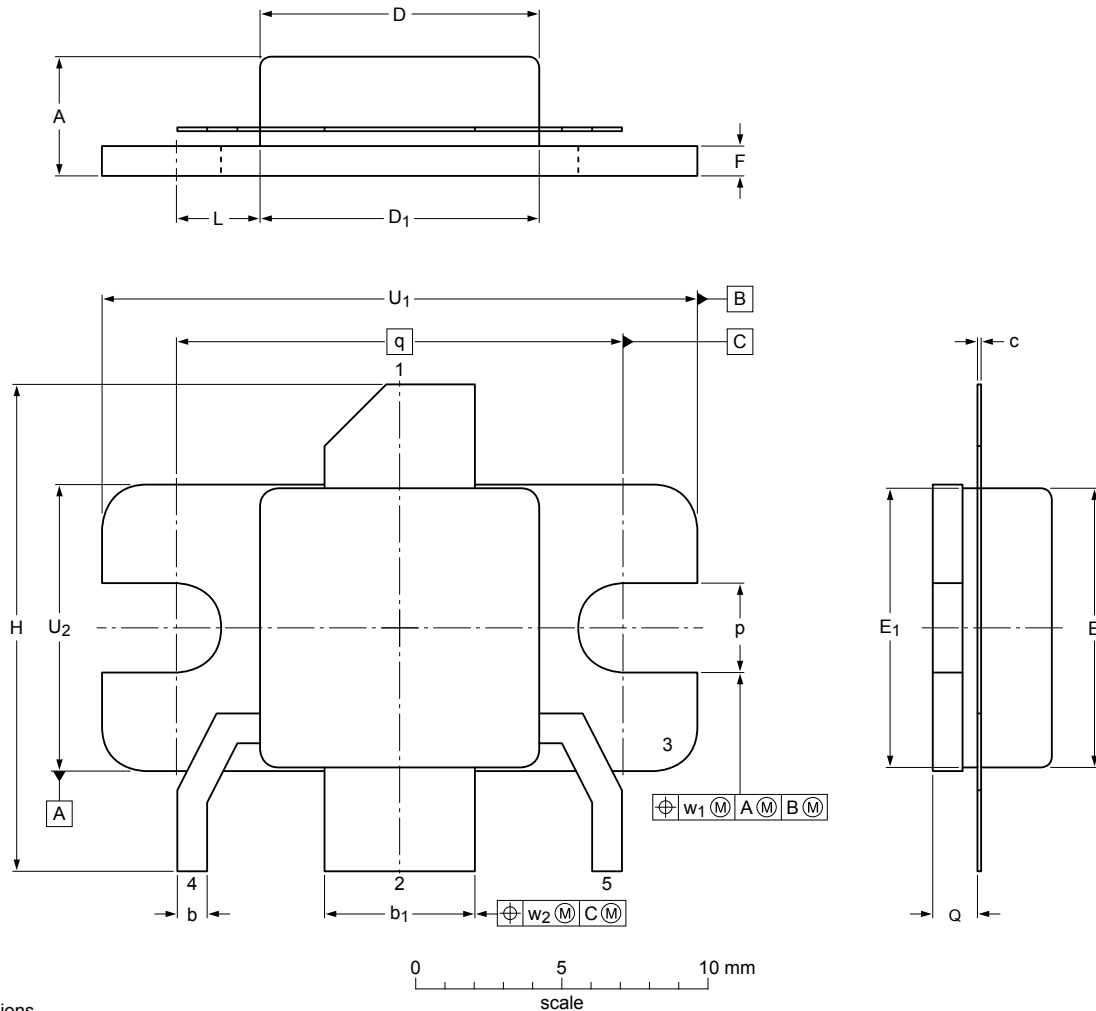

Dimensions

Unit ⁽¹⁾	A	b	b ₁	c	D	D ₁	E	E ₁	F	H	L	p	Q ⁽²⁾	q	U ₁	U ₂	w ₁	w ₂
mm	max	4.65	1.14	5.26	0.18	9.65	9.65	9.65	9.65	1.14	17.12	3.00	1.70	15.24	20.45	9.91	0.25	0.51
	nom	3.76	0.89	5.00	0.10	9.40	9.40	9.40	9.40	0.89	16.10	2.69	2.92		1.45	20.19		
inches	max	0.183	0.045	0.207	0.007	0.38	0.38	0.38	0.38	0.045	0.674	0.118	0.067	0.6	0.805	0.39	0.01	0.02
	nom	0.148	0.035	0.197	0.004	0.37	0.37	0.37	0.37	0.035	0.634	0.106	0.115		0.057	0.795		

Note

1. millimeter dimensions are derived from the original inch dimensions.
2. dimension is measured 0.030 inch (0.76 mm) from the body.

sot1130a_po

Outline version	References			European projection	Issue date
	IEC	JEDEC	JEITA		
SOT1130A					09-10-12- 10-02-02